

# Assembly Guide 06/10/2006

## Growall



- 1 **System pieces :**
- 1 Wall support (Back/Black)
  - 1 24-hole support(Front/White)
  - 1 Recycling bassin
  - 1 Nutriments distributor
  - 24 Mesh Baskets
  - 24 White basket covers
  - 5 1 1/4 (32mm) Screws
  - 5 Dry-wall Inserts
  - 1 3mm Union
  - 1 Tube attachment
  - 1 36" (900mm) Tube
  - 1 3mm T

- Required tools :**
- 1 Star-headed screwdriver
  - 1 Leveler
  - 1 Measuring Tape
  - 1 Pencil
  - 1 Plastic screw anchors
  - 1 Electric Screwdriver

Wisely choose a place to install your Growall system according to these facts :

- The nutriments distributor;
- Any other nearby system;
- Try to minimise the distance with the light;
- The minimum required space for the plants.

2



3



4



Trace a line with your leveler

measure the distance  
then trace a line on the surface.

5



6



Screw the recycling basin equally to the traced line on the wall with the provided screw.  
Repeat the last step but screw the tube attachment to the basin.  
Do not screw too tightly or you will not be able to insert the black wall support.

**For dry or masonry walls, use the plastics anchors.**  
**Position the basin and then mark the hole you need to bore with a pencil.**  
**Bore a hole of 1/4(6mm), insert the anchor fully and then screw the recycling basin.**

e

7



8



Insert the black wall support in the recycling basin's screws by using the slits at the bottom of the black wall support, position with the leveler and then screw.

Screw in the center of the wall support while verifying the position of the piece. Screw tightly but not too much.



Fix the upper part of the black wall support with the provided screws.  
Do not screw totally. You will further need to insert the nutrients distributor.



12



14

Install the "T" and the union on the 36"(900mm) tube (Pic 12).  
Insert the tube in one of the two holes made for that (Pic 13 AND 14).  
Position the "T" in parallel with the nutrients distributor (As shown on Pic 15).



11

Insert the nutrients distributor on the screws using the slits made especially for that.  
Screw tightly but not too much.

13



15



16

Insert the 36"(900mm) tube in the tube-attachment.



17

Fix the 24-hole culture support (white) on the small hooks of the back support (black) created for this.



18

Insert the baskets.



19

You could use the provided white covers if you are using small clay balls or any other small ingredients that could slip from the baskets.



20

If you reduce the number of baskets on each supports, ue the covers to block the light. Here are some idea of configuration for your inner cultures. To avoid light from touching the roots of the adjacent baskets, cover the slit and the hole on the white lid.

21



If you want to use rockwool as a culture method, we recommend that you use blocks (remove the paper), tighten it with your fingers and then insert it in the basket with the hole on the upper side.

22



23



There are more methods, clay balls or the bulky rockwool.

24



Growall with clay balls.

25



Growall with rockwool blocks.

26



To add another Growall system vertically, insert the black wall support provided with the new growall in the upper part of the one already installed by adding the tube-attachment with the screw already there. Screw and then restart the steps 8 to 17.

27



Put the top and the bottom tube together with the union provided for this.

28

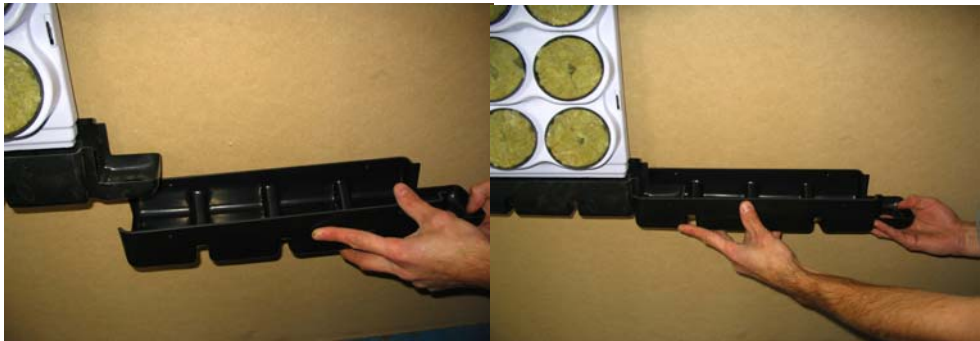

29



Insert the tube in the tube-attachment.



30

To add another growall system horizontally, Screw the recycling basin the the wall while inserting the dans l'ouverture rectangulaire opposée à la parti trouée de celle que vous allez installer au mur.



31

(si-dessus) Exemple de systèmes supplémentaires installés verticalement et horizontalement.



32

(si-dessus) Exemple de montage de la pompe et du filtreur. (Vendu séparément)

### Montage du distributeur à nutriment (Vendu séparément)

**Pompe :** Assurez vous que la pompe que vous vous procurerez soit capable de monter le liquide nutritionnel à la hauteur du distributeur de nutriments (Photo 10).

**Filtreur :** Utilisez un filtreur pour éliminer tous risques de blocage de la tuyauterie.

**Tubulure :** Utilisez une tubulure de (1/2" --13mm à 3/4" --19mm).



33

(si-dessus) Assemblage filtreur et connecteur rapide à la pompe (HydroSystem). (Vendu séparément chez votre détaillant)



(si-dessus) Exemple de montage d'un distributeur à nutriments en T. (Vendu Séparément)

34

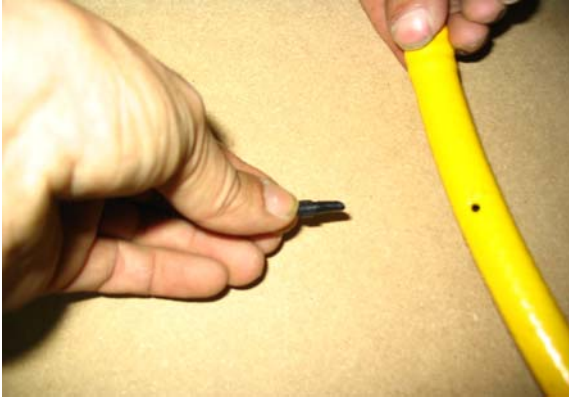

Percez un trou dans le tube d'alimentation vis à vis l'intérieur de la bassine de récupération.

35



Insérez l'union fournit et branchez s'y le tube de 36"( 90cm).

36



37



Installez un drain filtreur pour facilité la récupération des nutriments.  
(Drain non inclus)